

ABELL
SURVEYING & MAPPING
DELAVAN, WISCONSIN 53115
414-728-6737



NOTE: BEARINGS ARE REFERENCED TO
EXISTING SURVEY RECORDS.

SCALE 1"=30'

LEGEND

- - IRON PIPE FOUND
- - IRON ROD SET found 6/5/95
- X— - WIRE FENCE
- () - RECORDED AS

REVISED 6/5/95 TO SHOW
PROPOSED HOUSE LOCATION

ORDERED BY: PAULSON CONSTRUCTION
W4938 DUNBAR DRIVE
ELKHORN, WI 53121

ORDERED BY: JACKIE FLITCROFT
1501 SOUTH SHORE DRIVE
DELAVAN, WI 53115

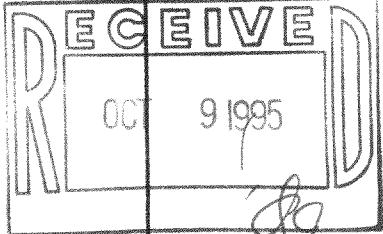

PLAT OF SURVEY OF

A parcel of land located in the Southeast 1/4 of Section 22, T 2 N,
R 16 E, Walworth County, Wisconsin, described as follows: Commencing at the southeast
corner of said Section 22; thence North along the east line of said Section 22, 571.33 feet;
thence N88°52'W along the south lines of Certified Survey No. 687 and Certified Survey No.
1438, 1297.52 feet to the most westerly corner of said Certified Survey 1438, and the place
of beginning; thence N25°30'W 99.48 feet; thence N66°25'E 147.73 feet; thence S40°50'E
105.19 feet; thence S66°48'W 175.58 feet to the place of beginning.

SUNSET
LANE

TAX PARCEL
FD-22-17
AREA = 0.37 ACRES

TAX PARCEL
FD-22-50

TAX PARCEL
FD-22-51

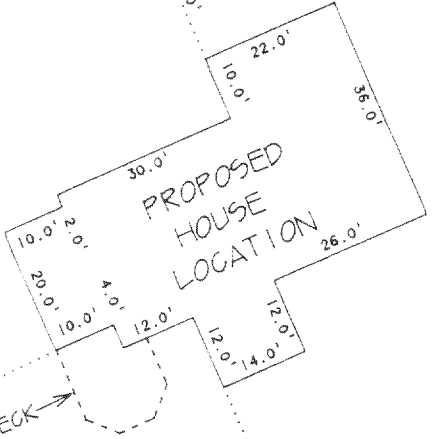

C.S.M. 2040
A REDIVISION OF LOT 4
OF C.S.M. 1438

I HEREBY CERTIFY THAT I HAVE SURVEYED THE ABOVE DESCRIBED PROPERTY AND THAT THE
ABOVE MAP IS A TRUE REPRESENTATION THEREOF AND SHOWS THE SIZE AND LOCATION OF
THE PROPERTY, ITS EXTERIOR BOUNDARIES, THE LOCATION OF ALL VISIBLE STRUCTURES
AND DIMENSIONS OF ALL PRINCIPAL BUILDINGS THEREON, BOUNDARY FENCES, APPARENT
EASEMENTS, ROADWAYS AND VISIBLE ENCROACHMENTS, IF ANY, TO THE BEST OF MY
KNOWLEDGE AND BELIEF.

THIS SURVEY IS MADE FOR THE USE OF THE PRESENT OWNERS OF THE PROPERTY, AND ALSO
THOSE WHO PURCHASE, MORTGAGE, OR GUARANTEE THE TITLE THERETO WITHIN ONE (1) YEAR
FROM DATE HEREON.

David F. Abell

DAVID F. ABELL
WISCONSIN REGISTERED LAND SURVEYOR, S-1596

March 29, 1994

REVISED DATE JUNE 5, 1995

DATE JOB NUMBER - 94033
NOTE: THIS IS NOT A CERTIFIED COPY UNLESS SEALED.

FD-22-17

216-2187